

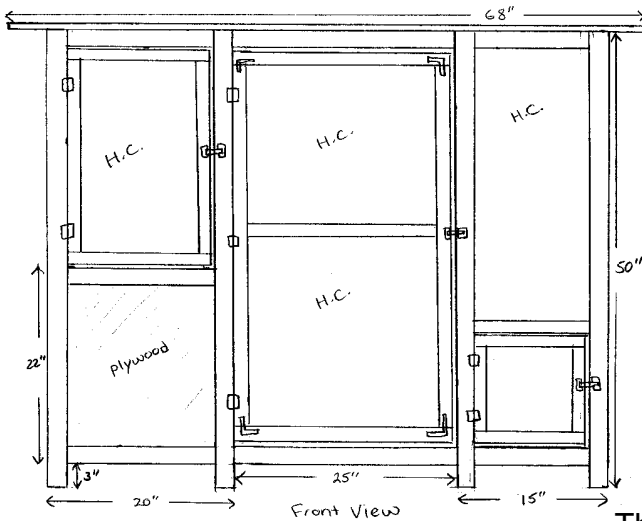

Small Outdoor Mammal Cage

This cage was designed to cost under \$100 to construct and to be predator proof. It can be used for a number of different animals, one common use is to transition squirrels from their acclimatizing climbing cages to a larger, walk-in pre-release cage. The large door in the middle is designed to allow the placement of the climbing cage inside to minimize handling, the small door on the right for food & water. Construction plans differ slightly from the photos in the placement of corner uprights.



Front view
<

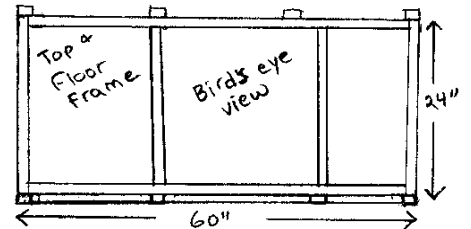

Left side View >
Right side all H.C.

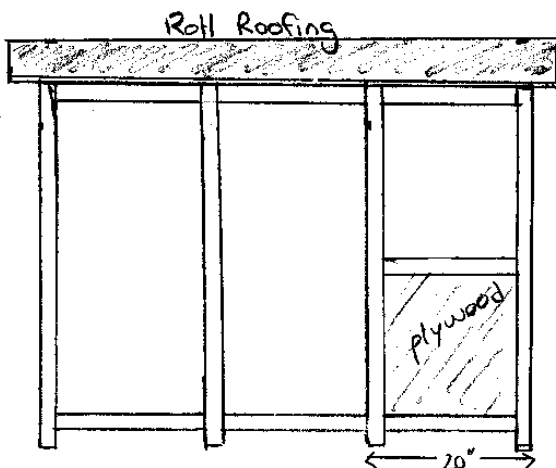
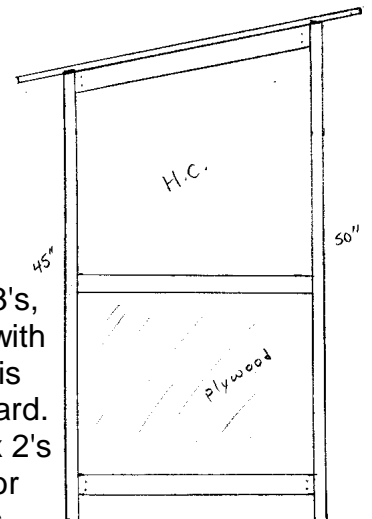

The frame is constructed of 2' x 3's, the top is 3/8" plywood covered with tar paper & roll roofing, the floor is 3/8" plywood covered with tileboard. The doors are constructed of 2' x 2's and 7 hinges, 4 corner braces (for the large door) and 3 barrel bolts.

Leave space around doors for expansion in wet weather. There is an enclosed area on the left side, it can be 22" high or extend to the top. I generally use a tarp over the cage during heavy rainfall.